

## Varibore Collets for CRS36, CRL42, QCRL42, CRL60, QCRL60, CRL80 & QCRL80 Collet Chucks

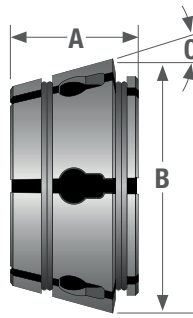

### Varibore Collets - Type: DIN 6343

- Round, Hexagon or Square
- Specify which gripping surface you require – Supergrip Serrations (Heavy duty), Annular serrations or Smooth
- Other shapes available upon request

### Dimensions (Metric)

Part No.	A	B	C
D671	38	56.5	14.75°
D673	39	61.5	14.75°
D677	45	85.5	14.75°
D660	48	1087.5	14.75°

Gripping Range	D671 DIN for CRS36			D673 DIN for CRL42 & QCRL42			D677 DIN for CRL60 & QCRL60			D660 DIN for CRL80 & QCRL80		
	mm	Round	Hexagon	Square	Round	Hexagon	Square	Round	Hexagon	Square	Round	Hexagon
4 - 6	D671-R06	D671-X06	D671-S06	D673-R06	D673-X06	D673-S06	-	-	-	-	-	-
6 - 8	D671-R08	D671-X08	D671-S08	D673-R08	D673-X08	D673-S08	D677-R08	D677-X08	D677-S08	-	-	-
8 - 10	D671-R10	D671-X10	D671-S10	D673-R10	D673-X10	D673-S10	D677-R10	D677-X10	D677-S10	-	-	-
10 - 12	D671-R12	D671-X12	D671-S12	D673-R12	D673-X12	D673-S12	D677-R12	D677-X12	D677-S12	-	-	-
12 - 14	D671-R14	D671-X14	D671-S14	D673-R14	D673-X14	D673-S14	D677-R14	D677-X14	D677-S14	D660-R14	D660-X14	-
14 - 16	D671-R16	D671-X16	D671-S16	D673-R16	D673-X16	D673-S16	D677-R16	D677-X16	D677-S16	D660-R16	D660-X16	-
16 - 18	D671-R18	D671-X18	D671-S18	D673-R18	D673-X18	D673-S18	D677-R18	D677-X18	D677-S18	D660-R18	D660-X18	-
18 - 20	D671-R20	D671-X20	D671-S20	D673-R20	D673-X20	D673-S20	D677-R20	D677-X20	D677-S20	D660-R20	D660-X20	-
20 - 22	D671-R22	D671-X22	D671-S22	D673-R22	D673-X22	D673-S22	D677-R22	D677-X22	D677-S22	D660-R22	D660-X22	-
22 - 24	D671-R24	D671-X24	D671-S24	D673-R24	D673-X24	D673-S24	D677-R24	D677-X24	D677-S24	D660-R24	D660-X24	-
24 - 26	D671-R26	D671-X26	-	D673-R26	D673-X26	D673-S26	D677-R26	D677-X26	D677-S26	D660-R26	D660-X26	-
26 - 28	D671-R28	D671-X28	-	D673-R28	D673-X28	D673-S28	D677-R28	D677-X28	D677-S28	D660-R28	D660-X28	-
28 - 30	D671-R30	-	-	D673-R30	D673-X30	D673-S30	D677-R30	D677-X30	D677-S30	D660-R30	D660-X30	-
30 - 32	D671-R32	-	-	D673-R32	D673-X32	-	D677-R32	D677-X32	D677-S32	D660-R32	D660-X32	-
32 - 34	D671-R34	-	-	D673-R34	D673-X34	-	D677-R34	D677-X34	D677-S34	D660-R34	D660-X34	-
34 - 36	D671-R36	-	-	D673-R36	D673-X36	-	D677-R36	D677-X36	D677-S36	D660-R36	D660-X36	-
36 - 38	-	-	-	D673-R38	-	-	D677-R38	D677-X38	D677-S38	D660-R38	D660-X38	-
38 - 40	-	-	-	D673-R40	-	-	D677-R40	D677-X40	D677-S40	D660-R40	D660-X40	-
40 - 42	-	-	-	D673-R42	-	-	D677-R42	D677-X42	D677-S42	D660-R42	D660-X42	-
42 - 44	-	-	-	-	-	-	D677-R44	D677-X44	-	D660-R44	D660-X44	-
44 - 46	-	-	-	-	-	-	D677-R46	D677-X46	-	D660-R46	D660-X46	-
46 - 48	-	-	-	-	-	-	D677-R48	D677-X48	-	D660-R48	D660-X48	-
48 - 50	-	-	-	-	-	-	D677-R50	D677-X50	-	D660-R50	D660-X50	-
50 - 52	-	-	-	-	-	-	D677-R52	D677-X52	-	D660-R52	D660-X52	-
52 - 54	-	-	-	-	-	-	D677-R54	-	-	D660-R54	D660-X54	-
54 - 56	-	-	-	-	-	-	D677-R56	-	-	D660-R56	D660-X56	-
56 - 58	-	-	-	-	-	-	D677-R58	-	-	D660-R58	D660-X58	-
58 - 60	-	-	-	-	-	-	D677-R60	-	-	D660-R60	D660-X60	-
60 - 62	-	-	-	-	-	-	-	-	-	D660-R62	D660-X62	-
62 - 64	-	-	-	-	-	-	-	-	-	D660-R64	D660-X64	-
64 - 66	-	-	-	-	-	-	-	-	-	D660-R66	D660-X66	-
66 - 68	-	-	-	-	-	-	-	-	-	D660-R68	D660-X68	-
68 - 70	-	-	-	-	-	-	-	-	-	D660-R70	-	-
70 - 72	-	-	-	-	-	-	-	-	-	D660-R72	-	-
72 - 74	-	-	-	-	-	-	-	-	-	D660-R74	-	-
74 - 76	-	-	-	-	-	-	-	-	-	D660-R76	-	-
76 - 78	-	-	-	-	-	-	-	-	-	D660-R78	-	-
78 - 80	-	-	-	-	-	-	-	-	-	D660-R80	-	-

Emergency Collets with soft face and pilot hole is available for all types